

The South East's leading manufacturer [®]



Ideal Windows

U.K. LTD.

Vertical Sliding (Sash) UPVC Windows

The Ideal vertical sliding window has been designed to incorporate all the desirable, traditional features of an authentic sash window but with the additional benefits and conveniences of UPVC.



They are designed with all the traditional detailing found in period windows, such as a deep bottom rail, slim sashes and an optional Georgian bar. Classic style brass catches and optional decorative horns replicate the traditional timber aesthetics to complete the effect.

Ideal vertical sliding sash windows are available in a variety of sizes and colours, which means that our windows are suitable for any style of home and shape of window. The slim sash is designed specifically to replicate the more elegant sightlines of traditional wooden windows. Available in a choice of Classic White, Soft Cream, Rich Rosewood or Warm Golden Oak.



Traditional colours



Classic White



Soft Cream



Rich Rosewood



Warm Golden Oak



Ideal Windows (UK) Ltd

www.idealwindows.co.uk

1 Lagoon Road, Orpington, Kent BR5 3QX | Tel: 01689 823388 | Fax: 01689 821110



BS7680:2001
KMS46070

BS7680:2001
KMS46067

BS7412:2007
KMS46068

BS4673:2009
KMS46065



Ideal Windows

U.K. LTD.

Vertical Sliding (Sash) UPVC Windows

Characteristics

Heritage profiles developed following extensive consultation with conservation bodies and housing associations

- Traditional timber aesthetics achieved by combining the 35mm putty-line heritage sash with the deep 75mm bottom rail
- Exterior of sash has putty-line aesthetics with matching astragal bar and inside is sculptured with matching astragal bar
- Option of mechanical or fully welded flush sill for tiled or stone sills
- Sash adapter profile available to enable equal sight-lines between top and bottom sashes
- Mullion adapter allows dummy frames to be fixed to a sliding element with the minimum of sight-lines

Appearance

- Available in white for traditional appearance
- A Georgian style shaped glazing bar available both internally and externally
- An all white finish possible using high performance silicone and EPDM seals

Reinforcement

Galvanised steel reinforcement is required above the following parameters:

- For frames over 1000mm width and/or 1300mm height or when no firm fixings to the structure of the building is available
- For sills where the length exceeds 1000mm
- Sashes must always be reinforced



Insulation

- Complies with the requirements of the Building Regulations covering Conservation of Fuel & Power - Part L (England & Wales) and Part J (Scotland) when glazed using the correct type of sealed unit
- Sound insulation is dependent on glazing specification

Fittings and Hardware

- Concealed sliding latches enable the sashes to be tilted inwards for ease of cleaning and to be restricted for safety
- Manufacturers recommendations on maintenance should be followed

Glazing

- 24mm double glazing
- Internally glazed sculptured bead for traditional internal joinery detail
- Dry glazed with co-extruded glazing bead

Vertical Section

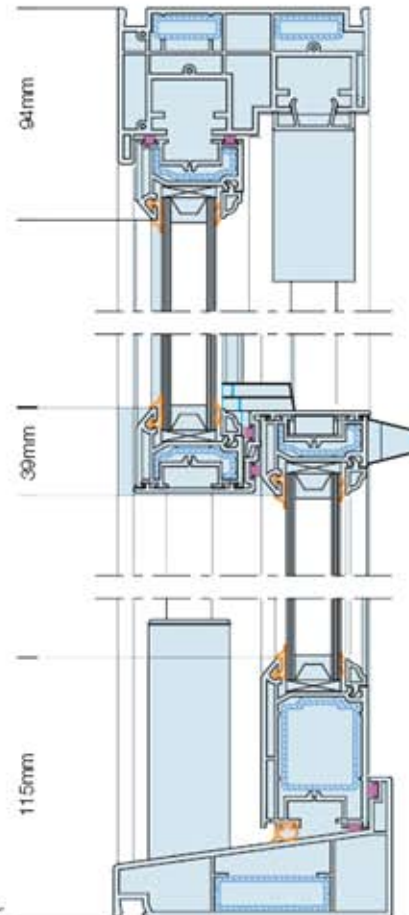

Maximum & Minimum Sash Sizes		Vertical Sliding Window	
NB: These sizes are for guidance only and are dependent on fittings and hardware used.			
Sash	Finish	MAX / MIN	
		W x H cm	m ²
Sash	White / Colour	150x300	0.45
Sash	White / Colour	450x450	0.20



Ideal Windows (UK) Ltd

www.idealwindows.co.uk

1 Lagoon Road, Orpington, Kent BR5 3QX | Tel: 01689 823388 | Fax: 01689 821110

